

PLAN TOPOGRAFIC

SCARA 1:1000

Amplasament Intravilan oras Bicz Zona "Podiceni" punct "Plutarie" jud. Neamt

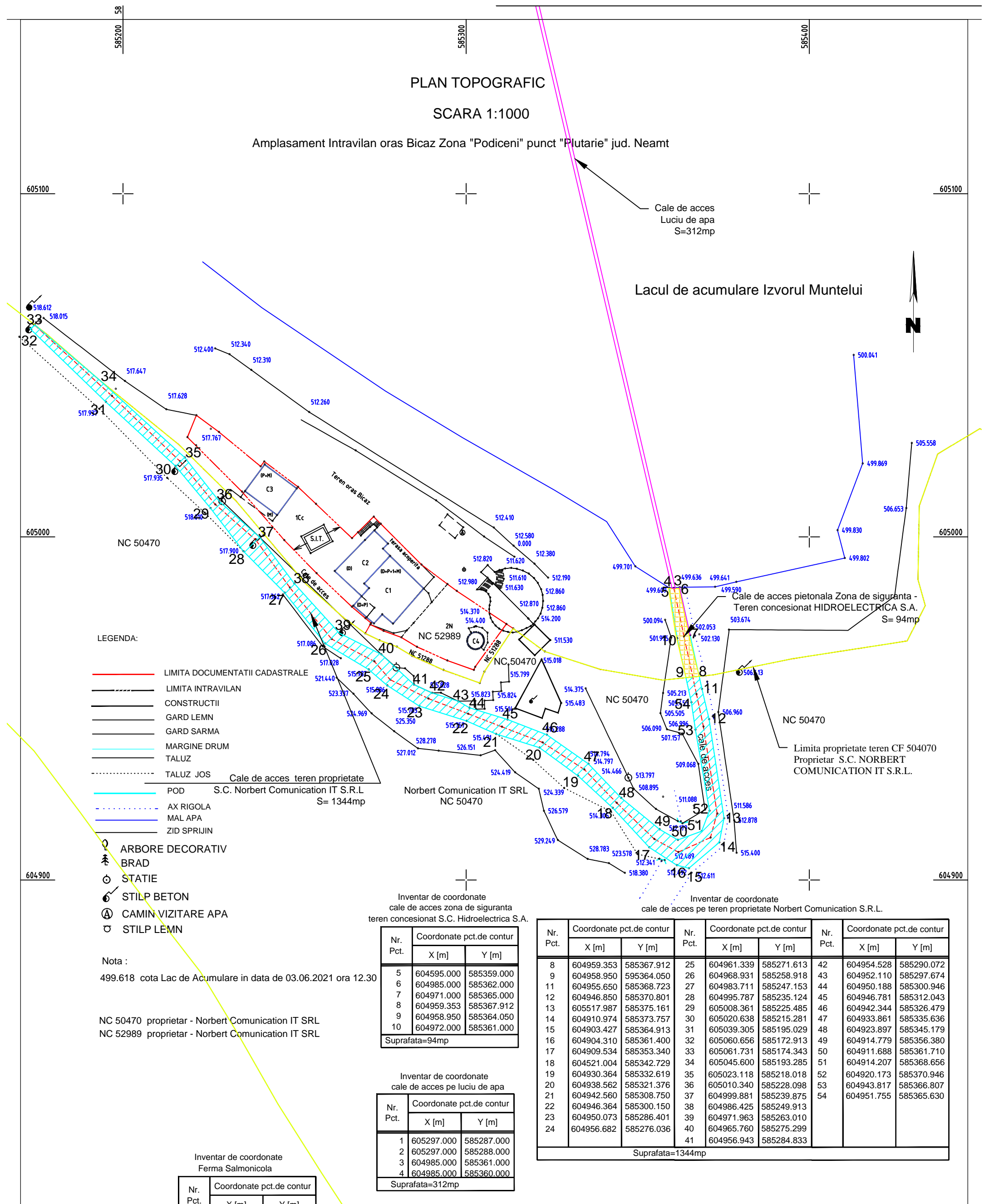

LEGENDA:

- LIMITA DOCUMENTATII CADASTRALE
- LIMITA INTRAVILAN
- CONSTRUCTII
- GARD LEMN
- GARD SARMA
- MARGINE DRUM
- TALUZ
- TALUZ JOS
- Cale de acces teren proprietate
- POD S.C. Norbert Communication IT S.R.L. S= 1344mp
- AX RIGOLA
- MAL APA
- ZID SPRIJIN
- ARBORE DECORATIV
- ⊕ BRAD
- ⊙ STATIE
- ⊙ STILP BETON
- ⊙ CAMIN VIZITARE APA
- ⊙ STILP LEMN

Nota :
499.618 cota Lac de Acumulare in data de 03.06.2021 ora 12.30

NC 50470 proprietar - Norbert Communication IT SRL
NC 52989 proprietar - Norbert Communication IT SRL

Inventar de coordonate cale de acces zona de siguranta teren concesionat S.C. Hidroelectrica S.A.

Nr. Pct.	Coordonate pct.de contur	
	X [m]	Y [m]
5	604595.000	585359.000
6	604985.000	585362.000
7	604971.000	585365.000
8	604959.353	585367.912
9	604958.950	585364.050
10	604972.000	585361.000

Suprafata=94mp

Inventar de coordonate cale de acces pe luciu de apa

Nr. Pct.	Coordonate pct.de contur	
	X [m]	Y [m]
1	605297.000	585287.000
2	605297.000	585288.000
3	604985.000	585361.000
4	604985.000	585360.000

Suprafata=312mp

Inventar de coordonate cale de acces pe teren proprietate Norbert Communication S.R.L.

Nr. Pct.	Coordonate pct.de contur		Nr. Pct.	Coordonate pct.de contur		Nr. Pct.	Coordonate pct.de contur	
	X [m]	Y [m]		X [m]	Y [m]		X [m]	Y [m]
8	604959.353	585367.912	25	604961.339	585271.613	42	604954.528	585290.072
9	604958.950	585364.050	26	604968.931	585258.918	43	604952.110	585297.674
11	604955.650	585368.723	27	604983.711	585247.153	44	604950.188	585300.946
12	604946.850	585370.801	28	604995.787	585235.124	45	604946.781	585312.043
13	60517.987	585375.161	29	605008.361	585225.485	46	604942.344	585326.479
14	604910.974	585373.757	30	605020.638	585215.281	47	604933.861	585335.636
15	604903.427	585364.913	31	605039.305	585195.029	48	604923.897	585345.179
16	604904.310	585361.400	32	605060.656	585172.913	49	604914.779	585356.380
17	604909.534	585353.340	33	605061.731	585174.343	50	604911.688	585361.710
18	604521.004	585342.729	34	605045.600	585193.285	51	604914.207	585368.656
19	604930.364	585332.619	35	605023.118	585218.018	52	604920.173	585370.946
20	604938.562	585321.376	36	605010.340	585228.098	53	604943.817	585366.807
21	604942.560	585308.750	37	604999.881	585239.875	54	604951.755	585365.630
22	604946.364	585300.150	38	604986.425	585249.913			
23	604950.073	585286.401	39	604971.963	585263.010			
24	604956.682	585276.036	40	604965.760	585275.299			
			41	604956.943	585284.833			

Suprafata=1344mp

Inventar de coordonate Ferma Salmonicola

Nr. Pct.	Coordonate pct.de contur	
	X [m]	Y [m]
a	605293.000	585214.000
b	605317.000	585255.000
c	605319.000	585285.000
d	605278.000	585286.000
e	605247.000	585218.000

Suprafata=3128mp

Data 03.06.2021

Sistem de Cote local
Sistem de proiectie STEROGRAFIC 1970

<p>SC EUDES PROJECT SRL PIATRA NEAMT</p>				Beneficiar:	BENEFICIAR: S.C. AGRONAUTICA S.R.L.	Proiect
				Denumirea proiectului:	PROIECT: FERMA SALMONICOLA Amplasament: extravilan oras Bicz, Lacul Izvorul Muntelui	
Specificatie:	Nume:	Semnatuara:	Data:	Titlu Plansa:	Plan de situatie	Plan Nr. H1.2
Masurat	SC TOPOPREST SRL		03.06.2021			
Proiectat	Ing. Ichim Alina		Data sept 2021			
Verificat	Ing. Ichim Alina			Scara 1:1000		